

INSTRUCTION SHEET

For Bulletin 511 Type "S" DC Brake 4" Brake

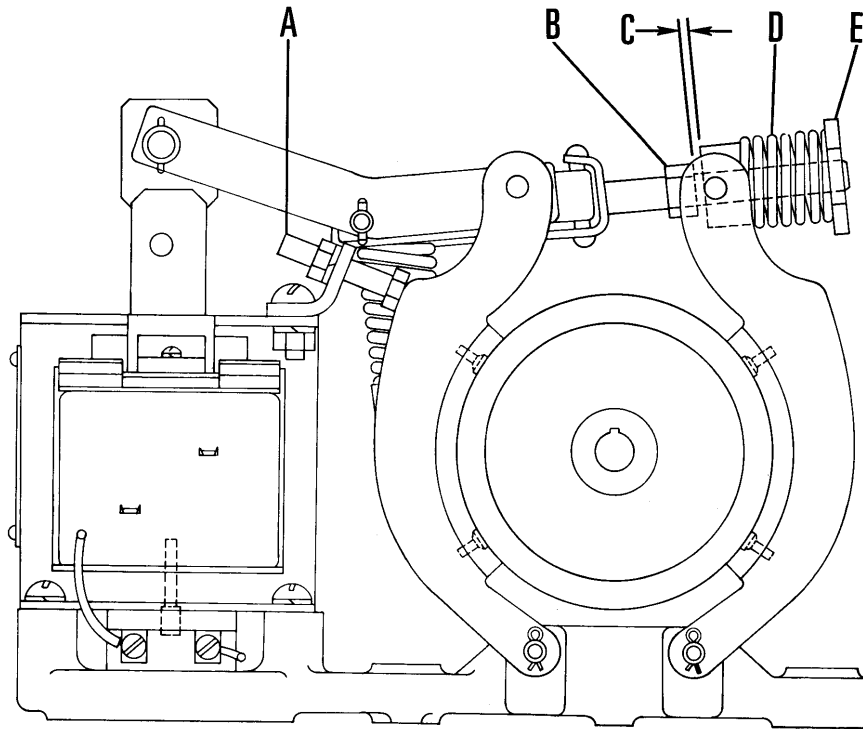

1. MOUNTING – Refer to Dimension Drawing

Push the solenoid plunger down to separate the brake shoes. The brake can then be slid over the wheel. Release the plunger to apply the shoes against the wheel. Insert shims between the mounting stand and the brake base until the brake is setting solid on the stand. Then fasten the brake to the stand with proper mounting screws or bolts. Note; These brakes **should** be mounted in a **horizontal** position with the base below the solenoid and shoes. Side or vertical mounting can result in accelerated wear of solenoid.

2. EQUALIZE SHOE CLEARANCE

With the brake released (solenoid plunger down) equalize the clearance between the shoes and wheel with screw "A". Be sure to tighten the lock nut when the adjustment is complete.

3. ADJUSTMENT

The brake is adjusted at the factory to provide the rated torque shown on the nameplate. If the load is stopped too rapidly and a lower torque is desired, increase the compressed length of spring "D" by holding the nut "B" to prevent rotation while turning nut "E" counter-clockwise. When the desired torque is obtained, be sure the "C" clearance dimension is 1/64". If the desired rated torque is other than shown on the nameplate, adjust spring "D" per table below following same procedure as lowering torque above.

4. READJUSTMENT FOR LINING WEAR

As the lining wears, the clearance "C" decreases. Never permit this clearance to become zero because complete loss of torque will result. When the clearance "C" becomes low, re-adjust to 1/64" by turning screw "E". No change in torque will result from this adjustment. Brake linings should be renewed before the groove pins are allowed to contact the wheel face.

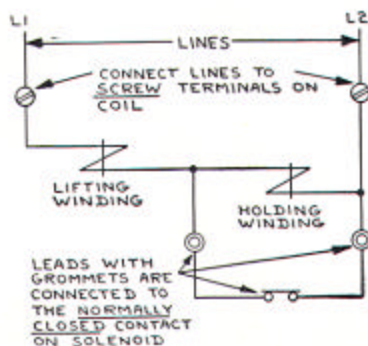

TORQUE ADJUSTMENT

Size Of Brake	Torque Rating	Compressed Length of Spring "D"
4"	3 Lbs. Ft.	1.350"
	10 Lbs. Ft.	1.225"
	15 Lbs. Ft.	1.100"

RENEWAL PARTS

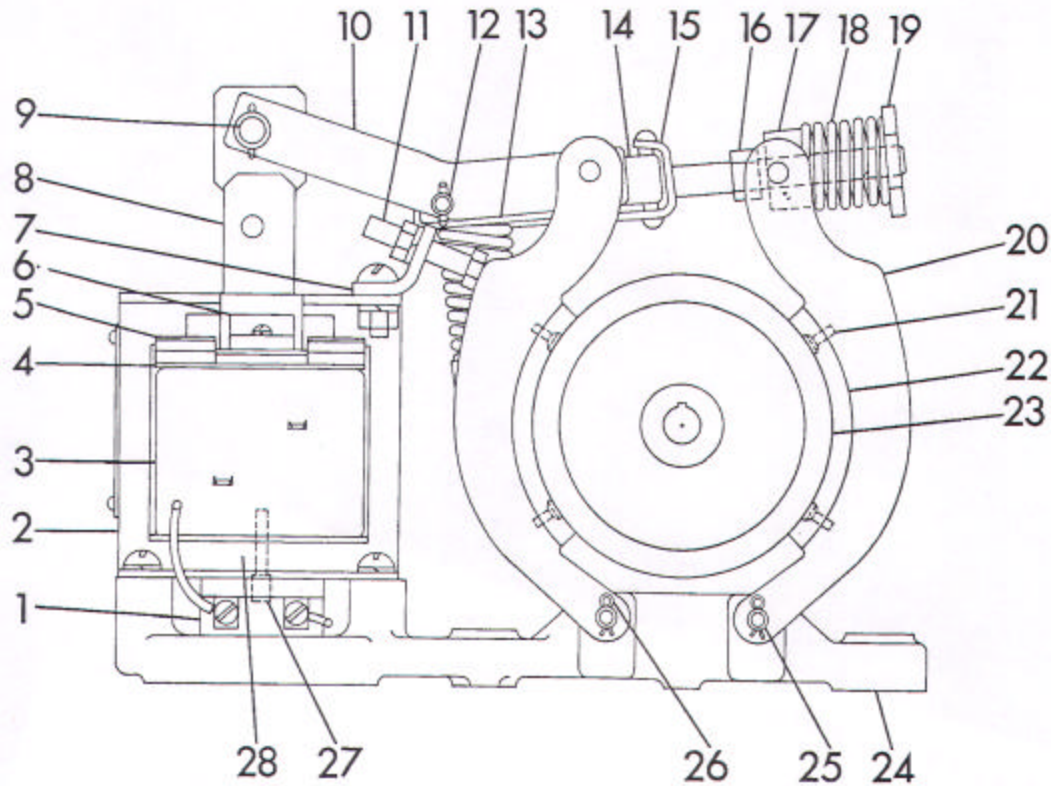

Item No.	Description Of Part	No. Req.	Part No.	Item No.	Description Of Part	No. Req.	Part No.
1	Switch Complete	1	10-1510-4	16	3/8-24 Locknut.....	1	15-292
2	Insulator	1	56-3573	17	3/8 washer.....	1	916-882Z
3	Solenoid Frame	1	17-10473-2	18	Pivot Block	1	17-473-3
4	Coil.....	1	Give No. On Coil	19	Spring	1	69-202
5	Washer.....	2	16-255	20	Adjusting Stud	1	14-272
6	Spring	2	69-276	21	Brake Shoe Complete (includes items 21 and 22)	2	48-306
7	Plunger Guide	2	54-300	22	Groov Pin	8	13-4762
8	10-32 X .31 RH Screw	3	911-490Z	23	Brake Lining	2	48-80-2
9	# 10 Helical Washer..	3	916-484Z	24	Brake Wheel (give complete number engraved on wheel)	1
10	Bracket	1	79-672	25	Base	1	17-10474
11	1/4-20 X .62 RH Screw	1	911-850Z	26	Pin	2	13-431
12	1/4-20 Hex Nut	1	915-24Z	27	Cotter Pin	4	913-22Z
13	1/4 Helical Washer..	1	916-682Z	28	Pin	2	13-620-5
14	Plunger Assembly	1	51-97-4	29	Solenoid without coil (includes items 2,4,5,6, & 8)	1	88-521-6
15	Link Pin	1	13-3864		Lining Kit (Includes items 21 and 22)	1	6-166
16	Spring Pin.....	2	13-3186				
17	Lever	1	24-4424				
18	1/4-20 X 1.50 Hex Screw	1	911-5452Z				
19	1/4-20 Hex Nut	1	915-24Z				
20	1/4 Helical Washer..	1	916-682Z				
21	Pin	1	13-3863				
22	Spring Pin.....	2	13-3186				
23	Spring	1	69-4908				
24	Adjusting Stud Nut	1	15-141				
25	Spring Gland	1	49-1978				